

Lucky[®]

LIFESTYLE



RECHARGABLE CLIPPER SET

complies with
INTERNATIONAL
IEC60335
SAFETY SPECIFICATIONS

L
8W

1YEAR
WARRANTY

Model:
LHC01



PLEASE READ ALL INSTRUCTIONS BEFORE USE

Dear customer,

Thank you for choosing to purchase a Lucky brand product. Thanks to its technology, design and operation and the fact that it exceeds the strictest quality standards, a fully satisfactory use and long product life can be assured

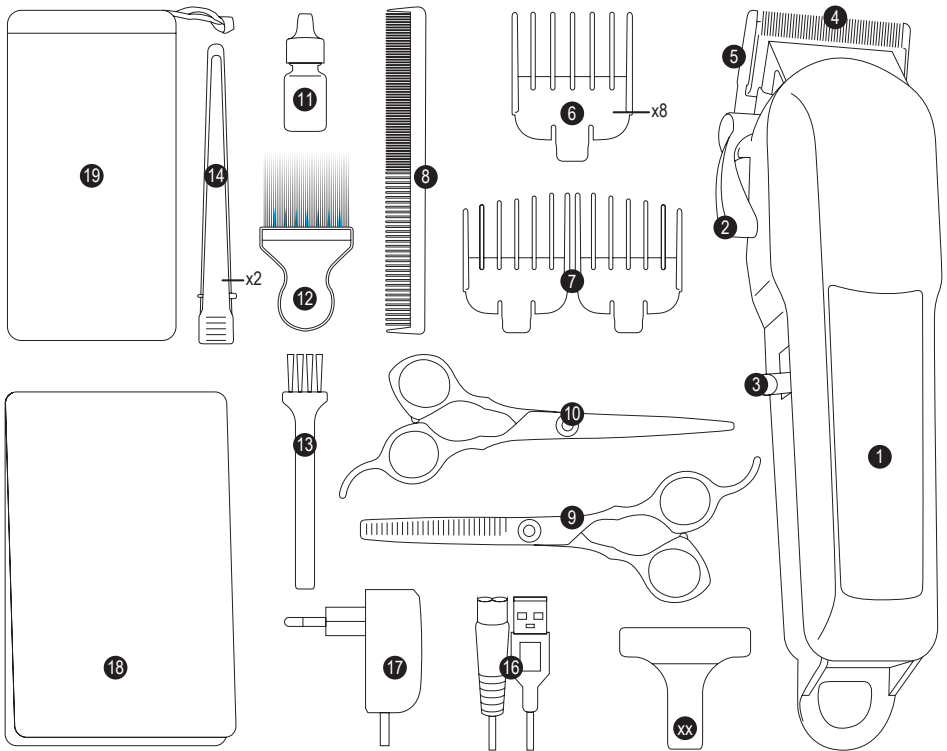

1. Parts description

- 1. Hair cutting unit with digital screen
- 2. Blade lever
- 3. On / off switch
- 4. upper blade
- 5. lower blade
- 6. Guide combs (#1-#8)
- 7. Tapering combs (left and right)
- 8. Comb
- 9. Thinning scissors
- 10. Cutting scissors

- 11. Oil
- 12. Neck brush
- 13. Cleaning brush
- 14. Clip x 2
- 15. Blade cover
- 16. USB charger
- 17. Removable charger
- 18. Cutting cape
- 19. Pouch

2. Safety advice and warnings!

Read these instructions carefully before switching on the appliance and keep them for future reference. Failure to follow and observe these instructions could lead to an accident. Clean all the parts of the product that will be in contact with head, as indicated in the cleaning section, before use.

2.1. Use or working environment:

- 2.1.1. Keep the working area clean and well lit. Cluttered and dark areas invite accidents.
- 2.1.2. Use the appliance in a well-ventilated area.
- 2.1.3. Do not place the appliance on hot surfaces, such as cooking plates, gas burners, ovens or similar items.
- 2.1.4. Keep children and bystanders away when using this appliance.
- 2.1.5. Place the appliance on a horizontal, flat, stable surface away from other heat sources.
- 2.1.6. Do not use the appliance in association with a programmer, timer or other device that automatically switches it on.
- 2.1.7. Do not use the appliance if the cable or plug is damaged.
- 2.1.8. Ensure that the voltage indicated on the rating label matches the mains power supply voltage before plugging in the appliance.
- 2.1.9. Connect the appliance to the mains power supply with an earth socket withstanding a minimum of 10 amperes.
- 2.1.10. The appliance's plug must fit into the mains power supply socket properly. Do not alter the plug.
- 2.1.11. If using a multi plug check ratings carefully as the current used by several appliances could easily exceed the rating of the multi plug.
- 2.1.12. If any of the appliance casings breaks, immediately disconnect the appliance from the mains power supply to prevent the possibility of an electric shock.
- 2.1.13. Do not use the appliance if it has

fallen on the floor or if there are visible signs of damage.

- 2.1.14. Do not force the power cord. Never use the power cord to lift, carry or unplug the appliance.
- 2.1.15. Do not wrap the power cord around the appliance.
- 2.1.16. Do not clip or crease the power cord.
- 2.1.17. Do not allow the power cord to hang or to come into contact with the surfaces.
- 2.1.18. Check the state of the power cord. Damaged or tangled cables increase the risk of electric shock.
- 2.1.19. Power cord should be regularly examined for signs of damage, and if the cord is damaged, the appliance must not be used.

2.2. Personal safety:

- 2.2.1. CAUTION: Do not leave the appliance unattended during use as there is a risk of an accident.
- 2.2.2. This appliance is only for domestic use, not for industrial or professional use. It is not intended to be used by guests in hospitality environments such as bed and breakfast, hotels, motels, and other types of commercial environments, even in farm houses, offices and other work environments.
- 2.2.3. This appliance is not intended for use by persons (including children) with reduced physical, sensory or mental capabilities, or lack of experience and knowledge, unless they have been given supervision or instruction concerning use of the appliance by a person responsible for their safety.
- 2.2.4. This appliance is not a toy. Children should be supervised to ensure that they do not play with the appliance.

2.3. Use and care:

- 2.3.1. Fully unroll the appliance's power cable before each use.
- 2.3.2. Do not use the appliance if the parts or accessories are not properly fitted.

2.3.3. Unplug the appliance from the mains power supply when not in use and before undertaking any cleaning task.

2.3.4. This appliance should be stored out of reach of children.

2.3.5. Do not store the appliance if it is still on/hot.

2.3.6. Never leave the appliance unattended when in use and keep out of the reach of children.

2.3.7. If, for some reason, the appliance was to catch fire, disconnect the appliance from the mains power supply and **DO NOT USE WATER TO PUT THE FIRE OUT.**

2.4. Service:

2.4.1. Make sure that the appliance is serviced only by suitably qualified technician, and that only original spare parts or accessories are used to replace existing parts/accessories.

2.4.2. If the power cord is damaged, the manufacturer or its service agent or a similarly qualified person must replace it to avoid a hazard.

2.4.3. Any misuse or failure to follow the instructions for use renders the guarantee and the manufacturer's liability null and void.

3. Instructions for use

3.1. Before use:

3.1.1. Remove the appliance's protective film (if applicable).

3.1.2. Before using the product for the first time, clean the parts that will come into contact with your head in the manner described in the cleaning section..

3.2. Charging the battery:

3.2.1. A new battery is not fully charged and must therefore be charged before the appliance is used for the first time.

3.2.2. Charge the battery at an atmospheric temperature of between 4 and 40°C.

3.2.3. Insert the charger jack into the socket of the appliance. The socket is located at the bottom part of the appliance.

3.2.5. Plug the charger into the mains.

3.2.6. The LED light will be illuminated during charging.

3.2.7. Once it is 100% charged, the display screen will show 100.

3.2.8. Approximately 4 hours are needed for a complete the charge of the battery.

3.2.9. Never attempt to overcharge the battery.

3.2.10. When the battery is charged disconnect the charger from the mains supply.

3.3. Aligning your blades:

3.3.1. Your clipper was carefully examined to ensure that the blades were oiled and aligned before leaving the factory.

3.3.2. Blades must be realigned if they have been removed for cleaning or replacement.

3.3.3. To realign the blades, each upper blade tip should be in line with the corresponding lower blade tip. (The bottom blade's teeth tips should be approximately 1.2mm below the top blade's teeth tips.)

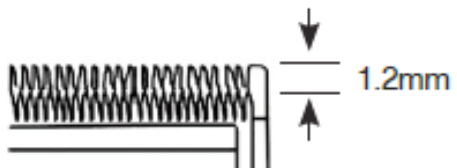

3.3.4. If the blade alignment is incorrect, add a few drops of oil to the blades, switch on the clipper for a few seconds, switch off and unplug. Loosen the screws slightly and adjust. Tighten the screws again after the blade is aligned.

3.3.5. To change the blades, use a Phillips screw driver to loosen the 2 screws.

3.3.6. Remove blade and replace it with a new blade.

3.3.7. Align the top blade then place the bottom blade over the top blade and insert the screws and tighten slightly.

3.3.8. Align the bottom blade as explained above and tighten the screws further to secure the bottom blade in place.

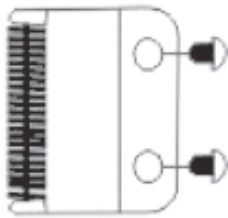

3.4. Oiling your clipper blades

3.4.1. To keep your clipper in peak condition, the blades should be oiled before every use.

3.4.2. Do not use hair oil, grease, and oil mixed with kerosene or any other solvent. The solvent will evaporate and leave a thick layer of oil which may slow down the blade's motion.

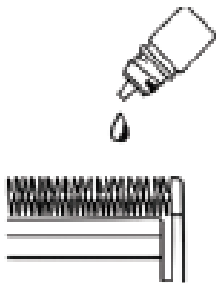

3.5. Adjusting the blade lever:

3.5.1. The lever is conveniently located on the side of the clipper, so it can easily be adjusted while the clipper is in your hand.

3.5.2. The lever adds versatility to the clipper by allowing a gradual change to the length of a cut without an attachment comb.

3.5.3. When the lever is in the uppermost position, the blades will give the closest cut leaving the hair very short. Pushing the lever gradually downward increases the cutting length.

3.5.4. In its lowest position, the lever will leave the hair approximately the same length as a #1 comb.

3.5.5. The lever will also extend the blade's life as a longer cut requires less work from the blades.

3.5.6. While the clipper is running, move

the Lever from "close cut" to "longer cut" several times. This will help keep cut hair away from the blades. If the clipper stops cutting, and the method above does not help, then the blades are blunt and need to be replaced.

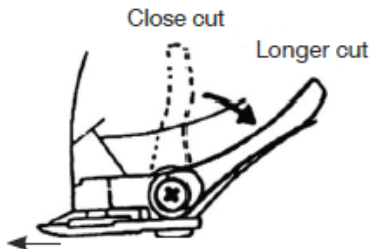

3.6. Guide combs:

3.6.1. Each comb attachment is marked accordingly on the outside surface (#1-#8).

3.6.2. To attach a comb, hold the comb with the teeth showing upward and slide it onto and along the clipper blade until the front of the comb firmly clicks into the clipper blade.

3.6.3. To remove the comb, simply pull the comb upward and away from the clipper blade.

3.7. Preparation for the hair cut:

3.7.1. Inspect the clipper, making sure that it is free of oil between the cutting blade teeth. Switch on the unit to distribute the oil and to ensure that it is running smoothly. Wipe off any excess oil. (This should be done after each use). Unwind and straighten the cord during use to avoid tangling.

3.7.2. Ensure that the person that is going to have their hair cut is properly seated and that the hair to be cut is at eye level. This allows visibility while cutting and control of the clipper.

3.7.3. Make sure that hair is dry for using the clipper.

3.7.4. Before cutting hair, brush/comb the hair so that it is straight & tangle free.

3.7.5. Place a towel around the neck and shoulders of the person having the

haircut.

3.7.6. NB: Cutting hair requires practice. When cutting for the first time, always use a longer comb and then change combs to cut hair shorter if required/ preferred.

3.8. Cutting the hair:

3.8.1. Nape of the neck

3.8.1.1. Attach guide comb attachment in accordance to your desired style.

3.8.1.2. Hold the clipper cutting edge pointing upwards and begin the haircut, starting in the middle of the base of the neck (see diagram 1).

3.8.1.3. Hold the clipper comfortably in your hand and hold lightly against the head with the comb teeth pointing upward. Gradually and slowly lift the clipper working upwards and outwards, through the hair, trimming just a little at a time.

3.8.1.4. As you cut, gradually lift the clipper head towards you. Continue to cut the back area from the bottom of the neck upwards to the top of the ears.

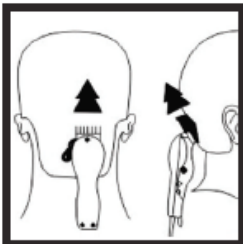

DIAGRAM 1

3.8.2. Back of the head

3.8.2.1. Change to the next longest guide comb attachment and cut the hair on the back of the head (see diagram 2).

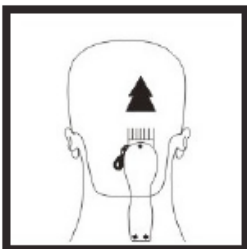

DIAGRAM 2

3.8.3. Side of the head

3.8.3.1. Change to one of the shorter guide combs, trim sideburns, i.e. the hair directly in front of the ears. Change to one of the longer guide combs, and continue to cut to the top of the head (see diagram 3).

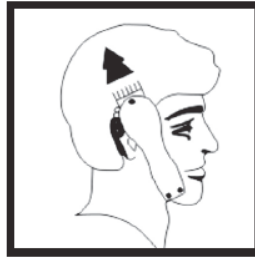

DIAGRAM 3

3.8.4. Top of the head

3.8.4.1. Using the longer guide comb attachment, cut the hair on the top of the head from back to front against the direction in which the hair normally grows (see diagram 4). In some cases, this may require the reverse, or cutting from front to back.

3.8.4.2. Smaller guide comb attachments are used to achieve a close crew cut or short cut.

3.8.4.3. For longer hair on top, lift the hair with a comb or hold the hair between your fingers and use the clippers to cut to the desired length (see diagrams 5 and 6). Always work from the back of the head. Hair can be cut shorter gradually by reducing the space between the comb/ fingers, and the head. Comb out trimmed hair and check for uneven strands.



DIAGRAM 4

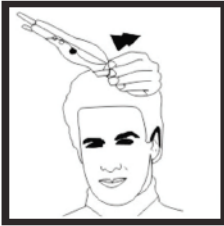

DIAGRAM 5



DIAGRAM 6

3.8.5. The finishing touches

3.8.5.1. Finally, use the blade without an attachment comb for close trimming around the base of the neck, the sides of the neck and the ears.

3.8.5.2. To produce a clean straight line at the sideburns, reverse the clipper by turning the reverse side upwards (see diagram 7).

3.8.5.3. Place the clipper at a 90° angle towards the head, allow the tips of the blades to lightly touch the skin and work downwards. This method will give a cut as clean as that of a razor.

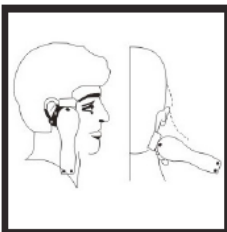

DIAGRAM 7

3.8.6. Short tapered styles (FLAT TOPS AND SHORT CUTS)

3.8.6.1. Starting with a longer attachment guide comb, cut from the back of the neck to the crown. Hold the attachment

guide comb flat against the head and slowly move the clipper through the hair, as shown (see diagram 8).

3.8.6.2. Use the same procedure from the lower side to the upper side of the head, as illustrated. Cut the hair against the direction to which it grows from the front to the crown and then level the cut with the sides.

3.8.6.3. To give a 'flat top' look, the hair on top of the head must be cut over the top of a flat comb instead of using the attachment guide comb.

3.8.6.4. Use closer cutting attachment guide combs to taper the hair down to the neckline as desired. Comb hair and check for uneven areas.



DIAGRAM 8

4. Cleaning and Maintenance

4.1. Disconnect the appliance from the mains power supply and allow it to cool completely before undertaking any cleaning task.

4.2. Clean the outer parts of the appliance with a damp cloth and then dry. **CAUTION!** Do not immerse electrical parts of the appliance in any liquid.

4.3. Do not use solvents, or products with an acid or base pH such as bleach, or abrasive products, for cleaning the appliance.

4.4. Never submerge the appliance in water or any other liquid or place it under running water.

4.5. During the cleaning process, take special care with the blades, as they are very sharp.

4.6. Clean the blades and the guide combs with the cleaning brush. Remove the hairs from the blades and from inside

the appliance with the brush. It is important to clean off remaining hairs after each use.

4.7. Do not use this appliance near water.

5. Anomalies and repair

5.1. Take the appliance to an authorised support centre if product is damaged or other problems arise.

5.2. If the connection to the mains has been damaged, it must be replaced, and you should proceed as you would in the case of damage.



Lucky guarantees that this product has been thoroughly inspected and tested before being dispatched and is free from mechanical and electrical defects and complies with the applicable safety standards. However, should defects due to faulty material or workmanship develop, under normal domestic use, within 6 months from the date of purchase please return the product to the store from where it was purchased for a full refund or replacement.

The following conditions apply:

- 1) Please ensure you original retain your receipt as this must be presented when making a claim under the terms of the warranty. It is impossible to determine the warranty period without your original proof of purchase, so please keep this in a safe place.
- 2) If a refund or exchange is required the product must be complete with all accessories, parts and packaging. Missing parts will render the warranty void.
- 3) Upon receipt of your appliance check it for any transport damage to ensure it is safe for use. Return it to the store as soon as possible for exchange if damaged. The warranty is void if products are damaged after use, so please do not use the damaged product.
- 4) Your product is designed for normal domestic household use. Failure to read and comply with the instructions for use, cleaning and maintenance will render your warranty void, so please read these instructions carefully to ensure your safety, and get the most effective use from the product. (e.g. lime scale; water deposits; and/or insect infestation)
- 5) Any abuse, negligent, improper or accidental use or care will render the warranty void and Creative Housewares (Pty) Ltd will not be liable for any loss or damage.
- 6) Any attempted repair, or replacement of unauthorised parts will render the warranty void, so please contact an authorised service centre or agent for any service or repair requirements.

Extended 12 Month Limited Warranty

Lucky offer an extended 12 month limited warranty from the date of purchase to offer the consumer peace of mind on their purchase. Should defects due to faulty material or workmanship develop, under normal domestic use, within 12 months from the date of purchase, please return the product to the store from where it was purchased for replacement.

Before returning your product, check for the following:

- 1) Your household mains supply socket is working and switched on.
- 2) The mains supply circuit is not overloaded (White trip switch on your DB board is off).
- 3) You have read the trouble shooting guide in your Instructions for Use.
- 4) All accessories and parts are present.

If service or repair becomes necessary outside the warranty period, this service is still available however all transport/postage, spares and labour costs will be paid by the consumer. All chargeable repairs will require the consumers' approval in writing once the quote is accepted. Once the go-ahead has been received Lucky will undertake to conduct the repair within a reasonable time and maintain the condition of the product as received.

All repairs carry a 3 month warranty. Lucky will attempt to conduct repairs within reasonable industry standards but cannot be held responsible or liable for any circumstances not under their direct control.

National Service Centre: 086 111 5006

e-mail: help@creativehousewares.co.za

creative housewares

web: www.creativehousewares.co.za

Cape Town

20 Tekstiel Street, Parow, Cape
Town, 7493, South Africa • PO. Box
6156 Parow East, 7501, South Africa
Tel: +27 21 931 8117
Fax: +27 21 931 4058

Durban

35 Adrian Road, Windermere,
Durban, South Africa, 4001
Tel: +27 31 303 3465
Fax: +27 31 303 8259

Johannesburg

9 Hamburg Road, Aeroport,
Spartan, Johannesburg,
South Africa
Tel: +27 11 392 5652
Fax: 086 567 9222

1 year warranty

creative housewares

🏠 20 Tekstiel St, Parow, cape Town, 7493, RSA

✉ P.O. Box 6156 Parow East, 7501, RSA

☎ +27 21 931 8117 / Helpline: 086 111 5006

📞 +27 63 014 0457 📠 +27 21 931 4058

🌐 www.creativehousewares.co.za