

Lucky[®]

LIFESTYLE



RECHARGEABLE TRIMMER SET

complies with
INTERNATIONAL
IEC60335
SAFETY SPECIFICATIONS

L
3W

1 YEAR
WARRANTY

Model:
BTRRTS7A

PLEASE READ ALL INSTRUCTIONS BEFORE USE



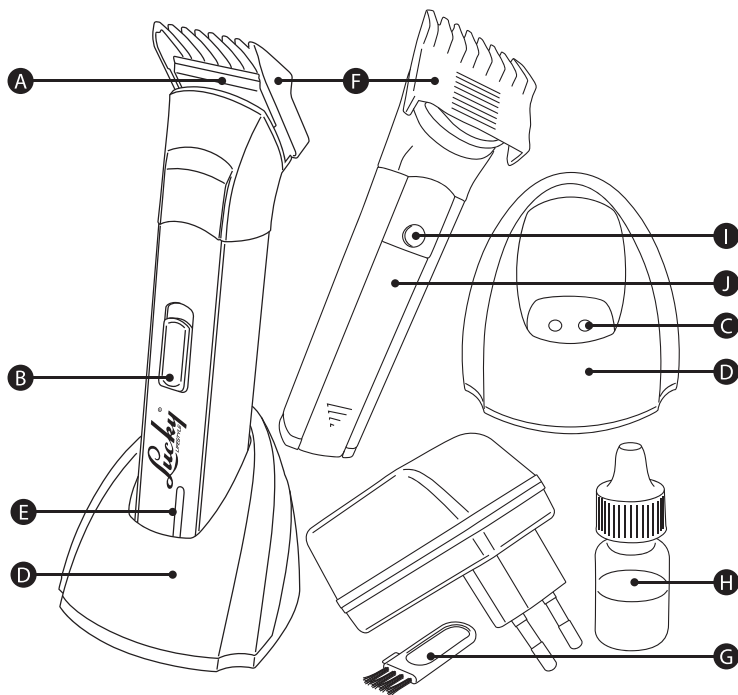

The set contains all the attachments and accessories you need to maintain a well-groomed look for your hair and beard.

Parts

- A. Wide trimmer attachment, cutting head
- B. ON/OFF switch
- C. Charging contacts
- D. Storage stand and charger
- E. Indicator lamp
- F. Clip-on comb attachment
- G. Cleaning brush
- H. Clipper oil
- I. Battery access button
- J. Battery compartment

How to use:

Setup of Battery

1. Open the battery compartment(J), using the battery access button(I).
2. Insert the rechargeable AA battery (supplied) into the battery compartment
3. Close the battery compartment

Preparing for use

The appliance as supplied by the manufacturer is not yet ready for use. It must be electrically charged prior to use.

1. Insert the plug of the battery charging stand (D) into socket. Warning! This appliance must be charged at the correct voltage (230V 50/60Hz).
2. Ensure appliance has been switched off, move switch(B) down 'off'.
3. Place appliance in the battery charging stand so that the indicator lamp (E) lights up.

A charging period of 16 hours is required before initial use. Keep charging contacts clean, soiled charging contacts may interfere with the recharge process. You may charge the appliance for more than 16 hours, it is not possible to over charge. Once the appliance has been charged, it is ready to use. It can be used with or without the clip-on comb.

Attachments

To attach the clip-on comb slide it onto the cutting head until it clicks into position.

To remove: Pull it off.

Hair Length Comb

The hair can be cut to 6 different lengths ranging from approximately 3mm to 14mm.

To adjust the comb attachment, simply slide it up or down the cutting head, you will hear it click into place.

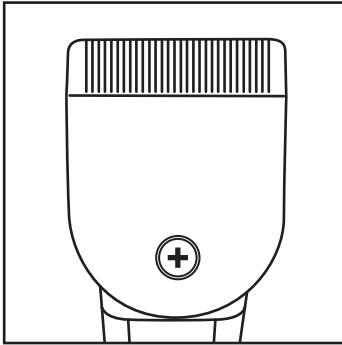

Fig.1

Cleaning

Clean your trimmer regularly to ensure your unit's operating life is not prematurely shortened.

Switch the appliance off before cleaning or carrying out maintenance!

1. Wipe the appliance with a damp cloth only, no solvents or lubricants may be used.
2. After use, take off the clip-on comb and remove any residual hair from the cutting head with a cleaning brush.
3. Oil the cutting head (Fig.1) using the supplied clipper oil.

Please note the following important safety information

- During charging, the clipper should be placed in a position where there is no contact with moisture, water or other liquids.
- Never try to remove foreign objects from the trimmer with a pointed tool, (e.g. a tail comb).

- Always switch the trimmer off before putting it down between cutting operations.
- Protect the cable from damage, do not pull, and keep away from hot surfaces.
- Do not touch the moving blades while the clipper is switched on.
- Do not use the trimmer if the cutter set is damaged or broken, this may lead to injuries.
- The appliance should not be exposed to temperatures below 0°C or above 40°C, avoid prolonged exposure to direct sunlight.
- Always turn the appliance off while it is being recharged.
- Keep out of reach of children.
- NO accessories or battery charging stands other than those supplied may be used with this appliance.

WARNING: Keep the appliance dry.

Electrical Safety

Correct Disposal of this product.

To prevent possible harm to the environment or human health from uncontrolled waste disposal, recycle it responsibly to promote the sustainable reuse of material resources. To return your used device, please use the return and collection system.

This appliance is not intended for use by persons (including children) with reduced physical sensory or mental capabilities, lack of experience and knowledge, unless they have been given supervision or instruction concerning the use of the appliance by a person responsible for their safety.

Children should be supervised to ensure that they do not play with the appliance.



Lucky guarantees that this product has been thoroughly inspected and tested before being dispatched and is free from mechanical and electrical defects and complies with the applicable safety standards. However, should defects due to faulty material or workmanship develop, under normal domestic use, within 6 months from the date of purchase please return the product to the store from where it was purchased for a full refund or replacement.

The following conditions apply:

- 1) Please ensure you retain your receipt as this must be presented when making a claim under the terms of the warranty. It is impossible to determine the warranty period without proof of purchase, so please keep this in a safe place.
- 2) If a refund or exchange is required the product must be complete with all accessories, parts and packaging. Missing parts will render the warranty void.
- 3) Upon receipt of your appliance check it for any transport damage to ensure it is safe for use. Return it to the store as soon as possible for exchange if damaged. The warranty is void if products are damaged after use, so please do not use the damaged product.
- 4) Your product is designed for normal domestic household use. Failure to read and comply with the instructions for use, cleaning and maintenance will render your warranty void, so please read these instructions carefully to ensure your safety, and get the most effective use from the product. (e.g. lime scale; water deposits; and/or insect infestation)
- 5) Any abuse, negligent, improper or accidental use or care will render the warranty void and Creative Housewares (Pty) Ltd will not be liable for any loss or damage.
- 6) Any attempted repair, or replacement of unauthorised parts will render the warranty void, so please contact an authorised service centre or agent for any service or repair requirements.

Extended 12 Month Limited Warranty

Lucky offer an extended 12 month limited warranty from the date of purchase to offer the consumer peace of mind on their purchase. Should defects due to faulty material or workmanship develop, under normal domestic use, within 12 months from the date of purchase, please return the product to the store from where it was purchased for replacement.

Before returning your product, check for the following:

- 1) Your household mains supply socket is working and switched on.
- 2) The mains supply circuit is not overloaded (White trip switch on your DB board is off).
- 3) You have read the trouble shooting guide in your Instructions for Use.
- 4) All accessories and parts are present.

If service or repair becomes necessary outside the warranty period, this service is still available however all transport/postage, spares and labour costs will be paid by the consumer. All chargeable repairs will require the consumers' approval in writing once the quote is accepted. Once the go-ahead has been received Lucky will undertake to conduct the repair within a reasonable time and maintain the condition of the product as received.

All repairs carry a 3 month warranty. Lucky will attempt to conduct repairs within reasonable industry standards but cannot be held responsible or liable for any circumstances not under their direct control.

National Service Centre: 086 111 5006

e-mail: help@creativehousewares.co.za

creative housewares

web: www.creativehousewares.co.za

Cape Town

20 Tekstiel Street, Parow, Cape
Town, 7493, South Africa • P.O. Box
6156 Parow East, 7501, South Africa
Tel: +27 21 931 8117
Fax: +27 21 931 4058

Durban

35 Adrian Road, Windermere,
Durban, South Africa, 4001
Tel: +27 31 303 3465
Fax: +27 31 303 8259

Johannesburg



9 Hamburg Road, Airport,
Spartan, Johannesburg,
South Africa
Tel: +27 11 392 5652
Fax: 086 567 9222

1 year warranty

creative housewares

 20 Tekstiel Street, Parow, Cape Town, 7493, South Africa

 P.O. Box 6156 Parow East, 7501, South Africa

 +27 21 931 8117  +27 21 931 4058

Service Centre Helpline: 086 111 5006

 www.creativehousewares.co.za